

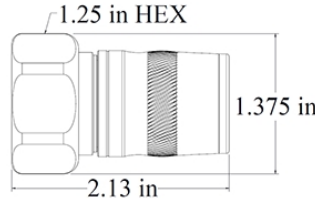

# UXP-DM-12

## 7-16 DIN Male Connector for 1/2" Annular Cable



[Installation video](#)



[Installation instructions](#)



Contact technical support:  
1-888-201-6073

[techsupport@jmawireless.com](mailto:techsupport@jmawireless.com)

General		Specification			
<b>Interface/gender</b>	7-16 DIN male				
<b>Cables supported<sup>1</sup></b>	<b>Manufacturer</b>	<b>P/N</b>	<b>Manufacturer</b>	<b>P/N</b>	
	JMA Wireless	JMA12-50	Wireless Supply	WS12	
		JMA12R-50		Eupen	EC4
	CommScope	LDF4	Leoni Flexline 1/2"R		
		LDF4RK	LS/Superior Essex	HFC 12D	
		LDF4 RN		HFAC 12D	
	RFS	LCF12	Hansen	RF5012	
		LCF12-50JL		RF5012Z	
	NK Draka	RFA1200	Belden	RA500	
Rosenberger	SL 1/2" R	RA500R			
<b>Weight</b>	0.311 lb   141.1 g				
<b>JMA Weather Protection System</b>	WPS-4A				
Tools required		JMA part number		Comment	
<b>Cable preparation</b>		SP-1/2-LDF4D		"U" bit	
<b>Connector compression</b>		HCG-FRAMESET-1/2, HCG-CC		Insert A	
<b>Torque wrench</b>		TQ-114-F18		18 lbf-ft   24.4 N·m	
Frequency band		VSWR		Return loss (dB)	
<b>DC-1000 MHz</b>		1.02		40	
<b>1000-2000 MHz</b>		1.03		36	
<b>2000-4000 MHz</b>		1.05		32	
<b>4000-6000 MHz</b>		1.08		28	
Electrical		Specification		Comment	
<b>Connector impedance</b>		50 ohm			
<b>Operating frequency band</b>		DC-6 GHz			
<b>3rd order IMD dynamic, (PIM)</b>		-161 dBc, typical		IEC 62037-2	
<b>DC test voltage</b>		4000 V			
<b>Center contact resistance</b>		≤ 0.8 milliohm			
<b>Outer contact continuity</b>		1.5 milliohm max.			
<b>Average power</b>		1100 W @ 900 MHz			
<b>Peak power, max.</b>		40 kW			
<b>Insertion loss, typical</b>		0.05 dB		Per connector	
<b>Shielding effectiveness</b>		< -120 dB		@ 0-1 GHz	
Mechanical		Specification		Comment	
<b>Pull force combined</b>		1.1 kN   >250 lb		Cable limited	
<b>Cable retention torque</b>		6.7 N·m   5 lbf-ft		Cable limited	
<b>Interface durability</b>		500 cycles		IEC 61169-4:9.5	

<sup>1</sup>For cable types not listed, please contact JMA Technical Support.



# UXP-DM-12

## 7-16 DIN Male Connector for 1/2" Annular Cable

Environmental	Specification	Test
Operating temperature	-55 °C to +85 °C (-67 °F to 185 °F)	
Storage temperature	-55 °C to +85 °C (-67 °F to 185 °F)	
Accelerated UV	1000 hr	ASTM G154
Immersion test method	Mated & unmated, IP68	IEC 60529:2001 & ANSI/SCTE 60
Water jetting test method	Mated & unmated, IP66	IEC 60529:2001
Mechanical shock test method	Pass	IEC 60068-2-27
Thermal shock test method	Pass	IEC 60068-2-14
Vibration test method	100 m/s <sup>2</sup> , 2 Hz to 200 Hz	IEC 61169-1:2003
Corrosion test method	1000 hr	IEC 60068-2-11

08/06/24