

8678800001

High Current PDU Fuses or Breakers

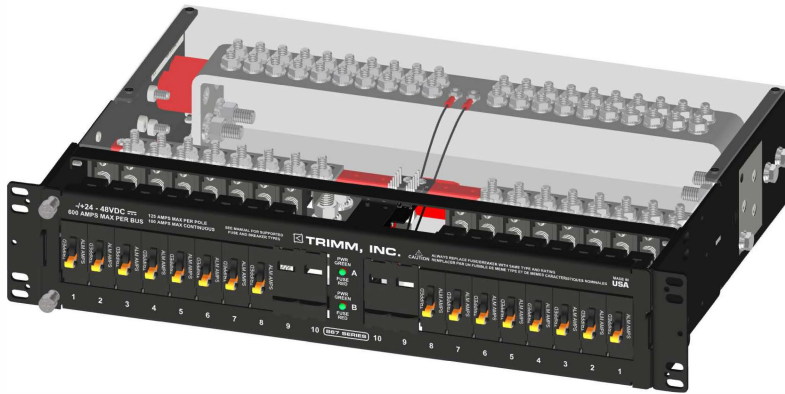

Positions Per Bus
8 Versa-Slots

Max Per Position
125 Amps

Bus Capacity
600 Amps

GENERAL	
Dimensions	19.00" W x 3.50" H x 14.500" D
Rack Space	2U (Includes a clear plastic top and bottom cover)
Weight	20.0 lbs.
Mounting	Universal 19" or 23", WECCO or EIA
Mtg. Pos.	Flush, 4" or 5" Offset
Finish	Black Textured Powder Coat w/zinc mtg
ELECTRICAL	
Input	Nominal Voltage -/+24-48V DC
	Voltage Range -/+19-60V DC
	Number of Buses 2
	Intr. Device Rating 750 Amps
Output	Max Rating by Type *TPS Fuse - 70 Amp *TLS Fuse - 125 Amp *Must purchase Fuse Holder Single Pole Breaker - 100A
	Continous Load Rating TLS Fuse - 100 Amp TPC Fuse - 100 Amp TPS Fuse - 56 Amp Single Pole Breaker - 80A
ALARMING	
Indicators	Bi-color LED Green (Power) Red (Alarm)
Function	Form C relay contacts for remote fuse and power fail indication
Conn. Type	Solderless Wire Wrap (18 to 30 AWG)
Rating	DC 30W/AC 50VA

Input	2 Hole Lug	Bat - 3/8" stud x 1" spacing, Rtn - 3/8" stud x 1" spacing or 1/4" stud x 5/8" spacing
	Wire Range	Up to 750 kcmil (x2)
	Max. Terminal Width	2.000"
	Tightening Torque	150 in-lb (16.9 Nm)
Output	2 Hole Lug	Bat - 1/4" stud x 5/8" spacing Rtn - 1/4" stud x 5/8" spacing or 3/8" stud x 1" spacing
	Wire Range	Up to 2/0 AWG
	Max. Terminal Width	0.625"
	Tightening Torque	24 in-lb (2.7 Nm)
Ground Bus	2 Hole Lug	1/4" stud x 1" spacing
	Wire Range	Up to 4/0 AWG
Short Term Op Temp	-5° C to +55° C	
Ambient	Up to 50° C	
Store Temp	-40° C to +70° C	
Humidity	0 to 95% non-condensing	
Dissipation	131 Watts max	
Safety (Recognized)	UL 60950-1/UL 1801/CSA C22.2 No.60950-1/EN 60950-1/IEC 60950-1, UL 62368-1	
Telcordia	NEBS Level 3 (GR-63/GR-1089) and GR-3108 Class 3 (w/o salt fog testing)	

High Current Power Distribution Unit, 8/8 Versa-Slots

8678800001

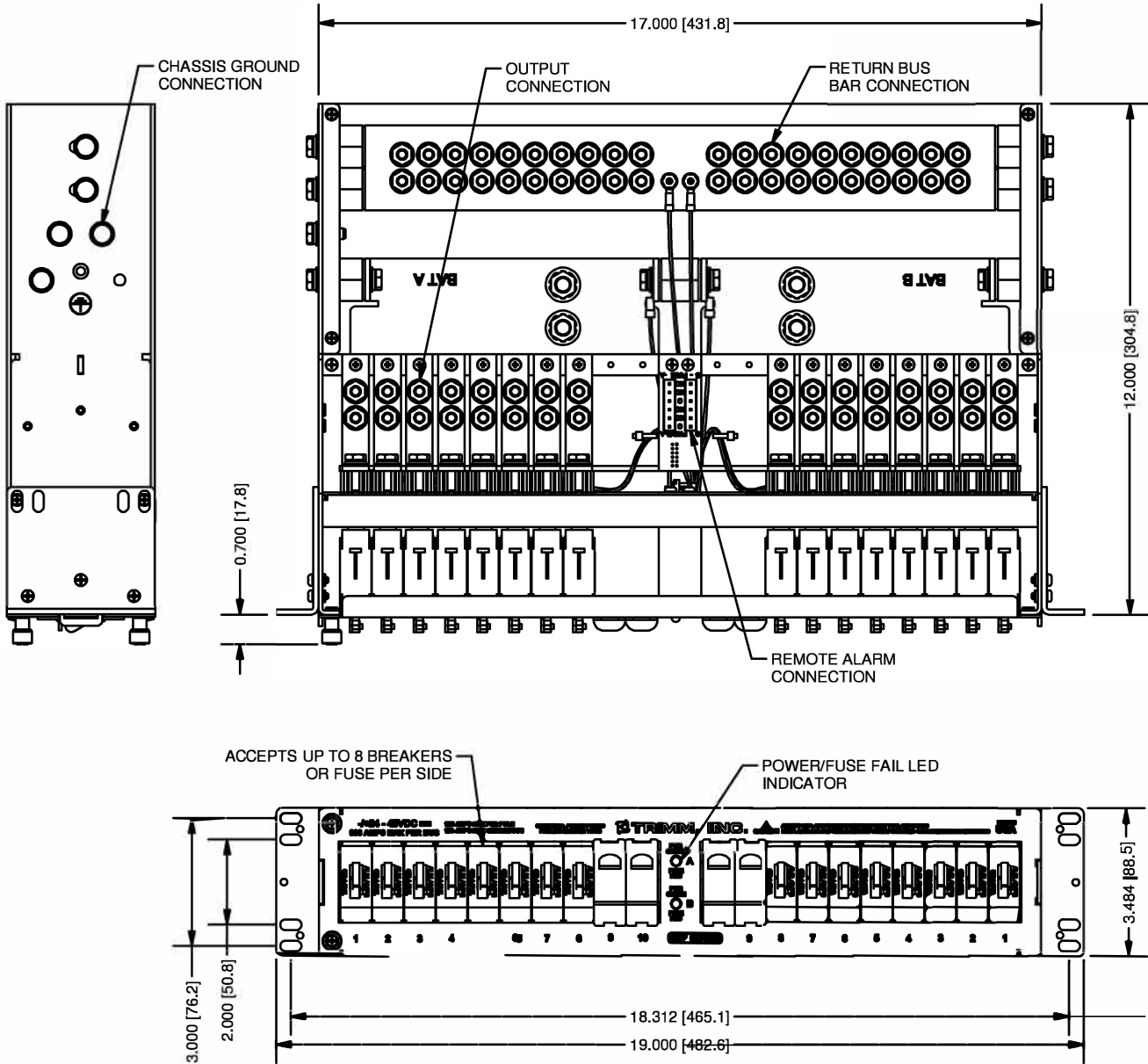

NOTES

Go to www.trimm-inc.com to order the fuses or circuit breakers for this panel. If you order TLS or TPS fuses with this panel, you will also need to order a fused disconnect for each fuse.